

18 ga. metal "C" studs fastened together with metal screws, typical @ corners. See specifications.

1 $\frac{1}{8}$ " WSF certified side wall panels. See specifications.

Drywall installed over the face of studs (optional)

4" or 6" x 18 ga. metal "C" studs spaced 12" o.c. @ side wall. See specifications.

1 $\frac{1}{8}$ " WSF certified front wall panels. See specifications.

4" or 6" x 18 ga. metal "C" studs spaced 10" o.c. @ front wall. See specifications.

Drywall installed over the face of studs

Fire retardant sound-proofing up 8'0" at front wall only. See specifications.

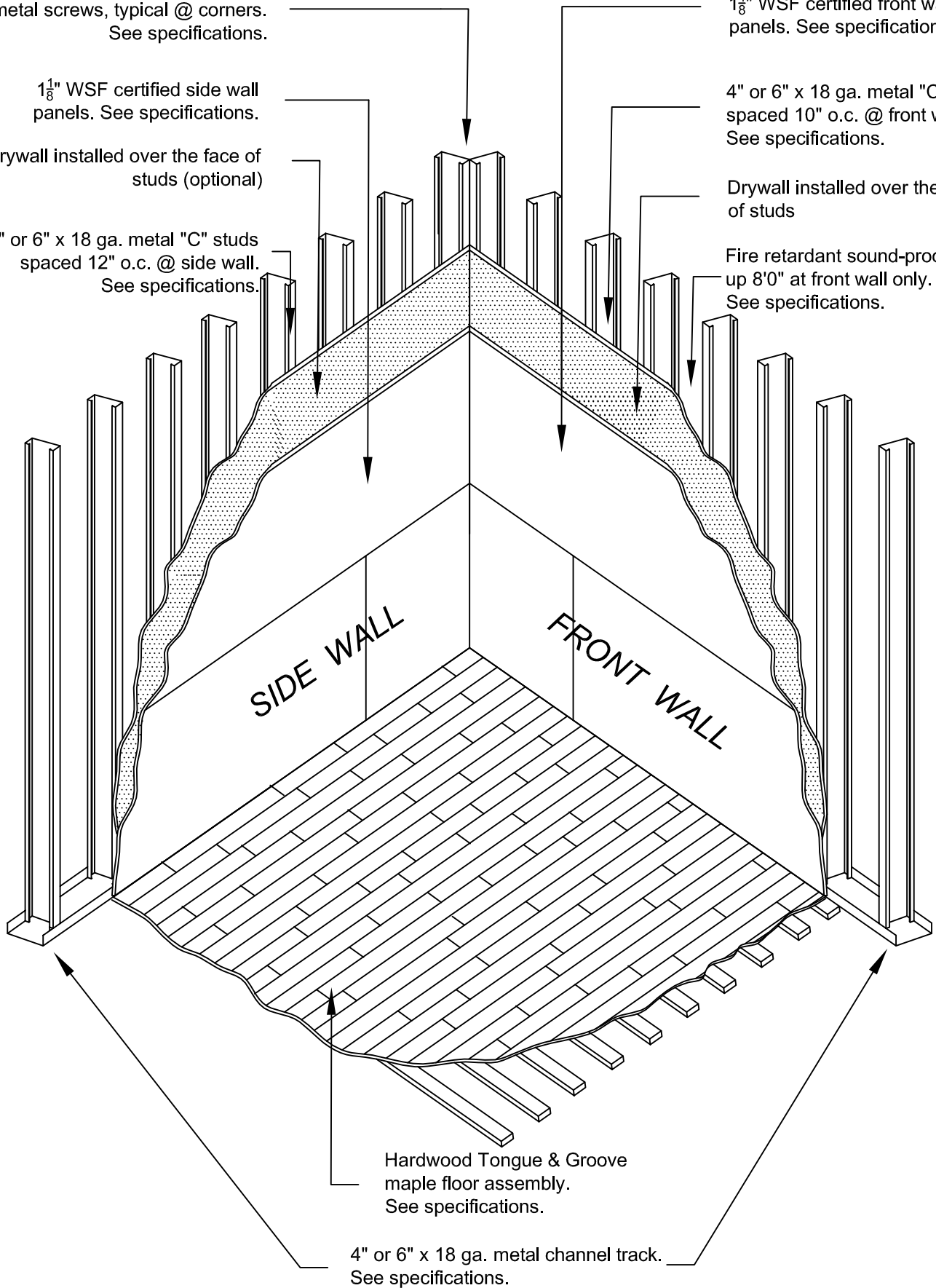

SIDE WALL

FRONT WALL

Hardwood Tongue & Groove maple floor assembly. See specifications.

4" or 6" x 18 ga. metal channel track. See specifications.



The Court Company
3059 Forest Hill-Irene Road
Germantown, TN 38138 USA

Drawings are submitted for review for contracted project and are to be used accordingly.
Drawings are not to scale.

Isometric of Squash Court (WSF)

Page